

General Information

The Bosch fuel pump installed on the Sterling 360™ has an idler gear, main drive gear, and mounting flange that are not supplied with the part, p/n ME223954. See **Fig. 1**. Therefore, when replacing the fuel pump, it is necessary to remove these parts from the old fuel pump and install them on the new fuel pump. The *Sterling 360™ Workshop Manual* does not provide torque values for the idler gear bolt, main drive gear nut, or mounting flange nuts.

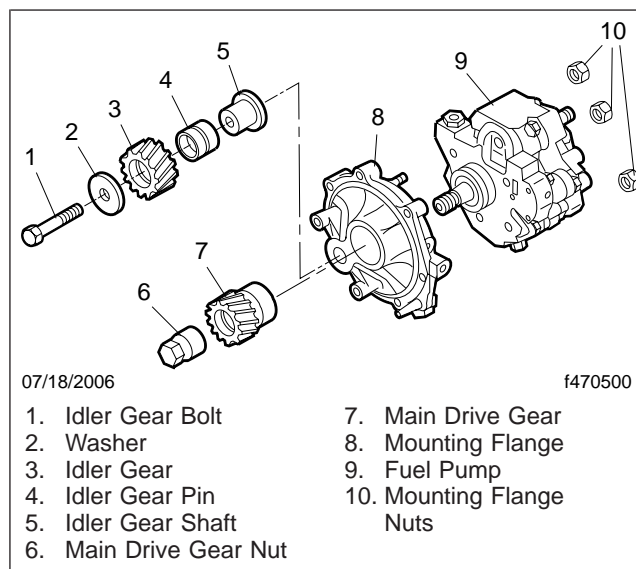

Fig. 1, Fuel Pump Components

Procedure

1. Remove the fuel supply pump from the front cover housing of the engine, following the procedures in Group 13A of the *Sterling 360™ Workshop Manual*.
2. Remove the idler gear bolt and the idler gear from the mounting flange.
3. Remove the main drive gear nut and the main drive gear from the mounting flange.
4. Remove the three mounting flange nuts and the mounting flange from the front of the old fuel pump.
5. Install the mounting flange on the front of the new fuel pump. Tighten the three mounting flange nuts 18 to 21 lbf·ft (25 to 28 N·m).
6. Install the main drive gear on the mounting flange. Tighten the main drive gear nut 74 to 81 lbf·ft (100 to 110 N·m).
7. Install the idler gear on the mounting flange. Tighten the idler gear bolt 27 to 39 lbf·ft (37 to 53 N·m).
8. Install the fuel supply pump on the front cover housing of the engine, following the procedures in Group 13A of the *Sterling 360™ Workshop Manual*.

Specifications

See [Table 1](#) for the torque values for the idler gear bolt, main drive gear nut, and mounting flange nuts.

Torque Values, Bosch Fuel Pump			
Description	Size	Part Number	Torque: lbf·ft (N·m)
Idler Gear Bolt	M10	MH000836	27–39 (37–53)
Main Drive Gear Nut	M18 x 1.5	ME222196	74–81 (100–110)
Mounting Flange Nuts	M8	MF434104	18–21 (25–28)

Table 1, Torque Values, Bosch Fuel Pump

Warranty

Normal warranty applies to Bosch fuel pumps. This bulletin is informational and does not give specific warranty information.